



## DOOR RELEASE UNITS – WALL-MOUNT FIRE DOOR HOLDERS



**DOORMOUSE WALL-MOUNT  
ELECTROMAGNETIC FIRE DOOR HOLDER**

### DESCRIPTION

Electromagnetic fire door holders are designed to hold open fire doors in any areas where easy access is essential.

Geofire fire door holders can be used in conjunction with any suitable fire alarm system. When an alarm is triggered, the power to the door holder is cut, allowing the fire door fitted with its standard closing mechanism, to shut automatically.

The Doormouse door holder is surface mounted and is housed in a white fire-resistant ABS casing. The units are fitted with an integral manual release button, allowing the door to be closed without operating the fire alarm.

The range is type tested to meet EN1155, knockouts for surface or back cable entry, and a spring-loaded pin to give zero residual holding force when de-energised.

The 230VAC unit includes a filter for EMC emissions and is CE marked. Internal diodes dissipate any “back EMF” on switch-off, reducing wear at the control unit.

The Doormouse range is ideal for use in any public access areas, including hospitals, offices, hotels and nursing homes.

### FEATURES

- 2 Year Warranty
- Approved to EN1155 & CE Marked
- 24VDC or 230VAC Supply Voltage
- Zero Residual Force
- 200N or 500N Holding Force Option
- Fire Resistant ABS Casing
- High Quality Cost-effective Package
- Supplied with Keeper Plate



# DOOR RELEASE UNITS – WALL-MOUNT FIRE DOOR HOLDERS

## SPECIFICATIONS

	GF-DM200-230	GF-DM200-24	GF-DM500-24
Supply Voltage	230 VAC	24 VDC	24 VDC
Holding Force	200 N	200 N	500 N
Power Rating	1.15 W	1.15 W	1.15 W
Residual Holding Force	Zero	Zero	Zero
Ambient Temperature	0 – 40 °C	0 – 40 °C	0 – 40 °C
Protection	IP 51	IP 51	IP 51
Casing	White fire-resistant ABS	White fire-resistant ABS	White fire-resistant ABS
Weight	360 g	360 g	500 g

## ASSEMBLY

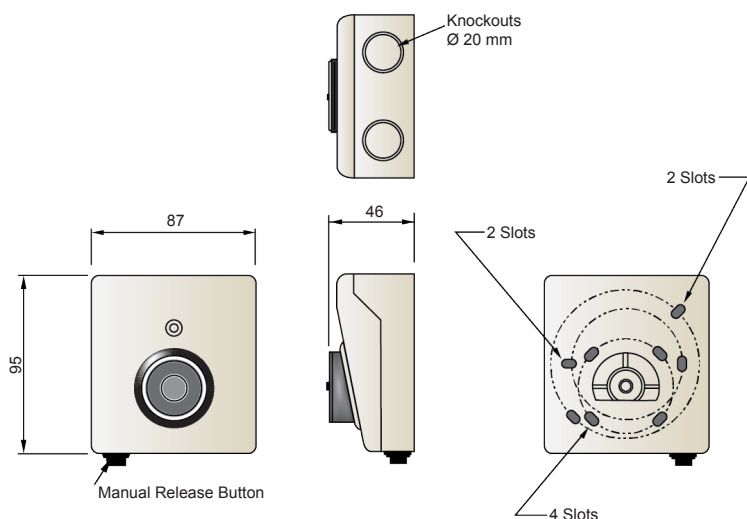

### Adjustable Keeper Plates Supplied as Standard

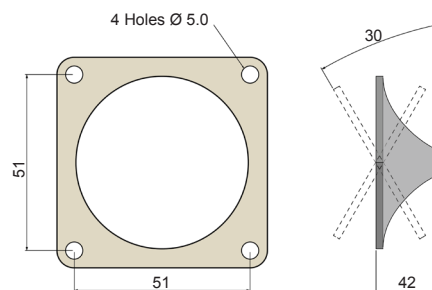

## ORDERING INFORMATION

Product Code	Product Description
GF-DM200-24	Type 87 Standard Doormouse 24VDC 200N
GF-DM200-230	Type 87 Standard Doormouse 230VAC 200N
GF-DM500-24	Type 87 Doormouse 24VDC 500N
GF-FM200-24	Type 84 Standard Floor Mounted Magnet 24VDC 200N
GF-FM500-24	Type 84 Standard Floor Mounted Magnet 24VDC 500N

• **DISCLAIMER:** Although the contents of our product literature have been prepared with the greatest care, Technoswitch can accept no liability whatsoever for any direct or indirect damages of any kind that may arise due to either errors or omissions in them, or amendments to products or other specifications following publication.



**HEAD OFFICE — JOHANNESBURG**  
Cussonia Park, 3 Ridge Road, Laser Park, Johannesburg **T** +27 (0)11 794 9144 **E** info@technoswitch.co.za  
**CAPE TOWN** **T** +21 948 4575 **DURBAN** **T** +27 (0)31 266 8843

[www.technoswitch.co.za](http://www.technoswitch.co.za)

Document: DS GF-DMx Door Holder Range 201104 E & OE